

NovaSeptum® Bag Rack for Single Sampling Units

Product Description

The NovaSeptum® Bag Rack for Single Sampling Units is designed to easily load and unload NovaSeptum® sampling units. It is fully adjustable and available for all standard holders. A certificate of quality is included in each box.

NovaSeptum® Bag Rack for Single Sampling Units

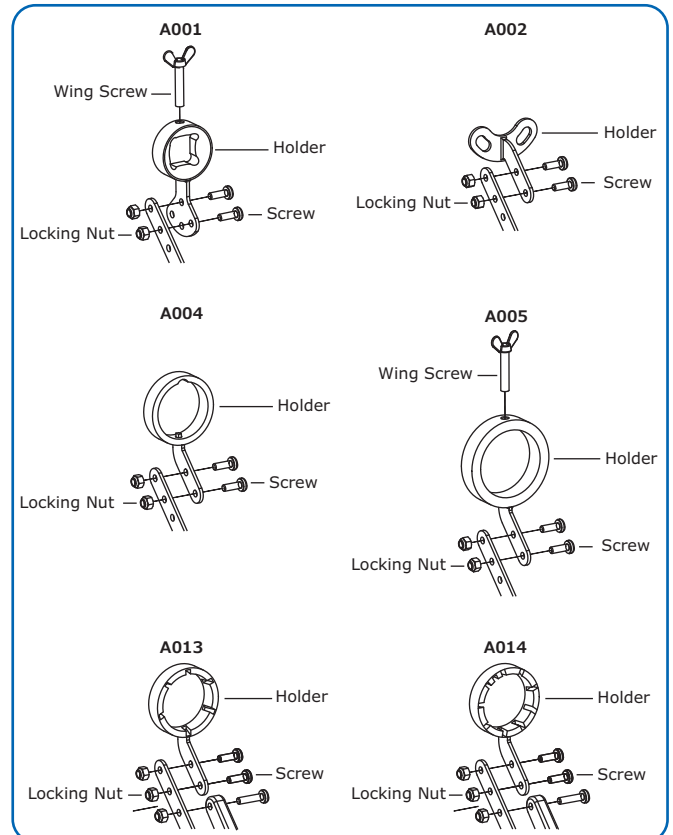
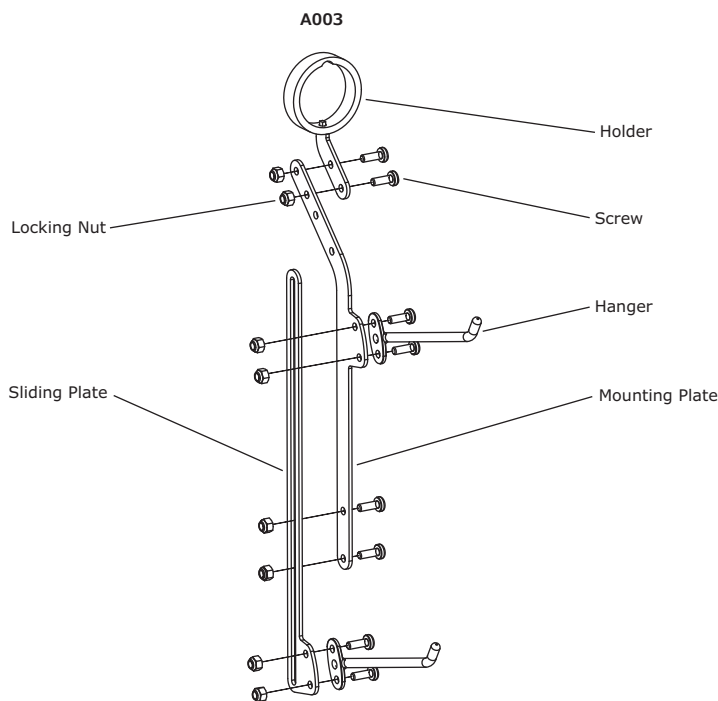

Specifications

Material	
Mounting plate	AccuSizer particle size distribution
Sliding plate	Stainless steel in compliance with ASTM® 316
Hanger	Stainless steel in compliance with ASTM® 316
Holder	Stainless steel in compliance with ASTM® 316
Screw	Stainless steel in compliance with A4
Locking nut	Stainless steel in compliance with A4
Wing nut (A005)	Stainless steel in compliance with A4

Nominal Dimensions	
Length x width x height	A001: 250 mm (9.8 in.) x 280 mm (11 in.) x 260–460 mm (10.2–18.1 in.)
	A002: 250 mm (9.8 in.) x 30 mm (1.2 in.) x 260–460 mm (10.2–18.1 in.)
	A003: 250 mm (9.8 in.) x 280 mm (11 in.) x 260–460 mm (10.2–18.1 in.)
	A004: 250 mm (9.8 in.) x 30 mm (1.2 in.) x 260–460 mm (10.2–18.1 in.)
	A005: 250 mm (9.8 in.) x 30 mm (1.2 in.) x 260–460 mm (10.2–18.1 in.)
Weight	0.5 kg
Maximum load	5 kg

Environmental	
Packaging	A package of 1 bag rack unit with all of its parts is packed unassembled in a cardboard box with a part number.

Ordering Information

Novaseptum® Bag Rack for Single Sampling Units

Novaseptum® Holder (mm O.D.Ø)	Cat. No.
1-port holder, TC 25 in-line	A001
1-port holder, TC 25/NAC 18	A002
5-port holder, TC 50.5 for NAC-A, NAC-D, NAC-I, NAC-S	A003
9-port holder, TC 64 for NAC-A, NAC-D, NAC-I, NAC-S	A004
Ingold® holder	A005
5-port holder, TC 50.5 for NAC-USI, NAC-USM	A013
9-port holder, TC 64 for NAC-USI, NAC-USM	A014

MilliporeSigma
400 Summit Drive
Burlington, MA 01803

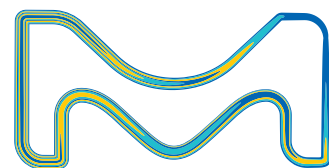

To Place an Order or Receive Technical Assistance

Please visit [EMDMillipore.com/contactPS](https://www.emdmillipore.com/contactPS)

For additional information, please visit [EMDMillipore.com](https://www.emdmillipore.com)